

# BACK BAR EQUIPMENT

## Model: **BB69SNSSSGD**

Natural Refrigerant R-290 Model

### 69" Back Bar Display Cooler with Sliding Glass Doors Shallow Depth

Stainless steel exterior, countertop, interior back and side panels with reinforced stainless steel floor.



## Options and Accessories

(upcharge and lead times may apply)

|                                 |   |
|---------------------------------|---|
| Additional epoxy coated shelves | Food storage rated stainless steel interior (NSF-7) |
| Stainless steel shelves         | Casters or legs                                     |
| Wine rack                       | Compressor right (standard on left)                 |
| Riser base*                     | Slide-guard lock                                    |

Consult factory for other model configurations, options and accessories.

\* Adding a Riser Base increases overall height 2"

**Continental**<sup>®</sup>  
Refrigerator



Project Name:

Model Specified:

Location:

Item No:

Quantity:

AIA #:

SIS #:

## Standard Model Features

### REFRIGERATION SYSTEM

Performance rated front breathing refrigeration system

Natural, environmentally safe, high efficiency R-290 refrigerant<sup>1</sup>

Automatic, hot gas condensate evaporator

Extra large, balanced evaporator coil

### CABINET ARCHITECTURE

High density, non-CFC polyurethane foamed-in-place insulation

Front, rear and side venting louvered grills

Double pane, tempered low emissivity sliding glass doors

Stainless steel reinforced threshold

### MODEL FEATURES

Low profile cabinet design

Electronic control, off cycle defrost

LED interior lighting

Easily accessible and serviceable slide-out condensing unit

<sup>1</sup> R-290 refrigerant meets all federal and state regulatory requirements.

APPROVAL:

## Model Specifications

### DIMENSIONAL DATA

|  |                 |
|--|-----------------|
| Net Capacity (cubic feet)                            | 18 (510 cu l)   |
| Width, Overall (inches)                              | 69 (1753 mm)    |
| Depth, Overall (inches)<br>(including top & bumpers) | 24 (610 mm)     |
| Depth, Body Only (inches)<br>(less doors)            | 21 (533 mm)     |
| Height, Overall (inches)                             | 34 3/4 (883 mm) |
| Bottle/Can capacity (12oz)                           | 65 (per shelf)  |
| Number of Doors                                      | 2               |
| Number of Shelves                                    | 4               |

### REFRIGERANT DATA

|                             |      |
|-----------------------------|------|
| Condensing Unit Size (H.P.) | 1/4  |
| Capacity (BTU per hour)*    | 2250 |

### ELECTRICAL DATA

|  |                     |
|--|---------------------|
| Voltage (International)                        | 115/60/1 (220/50/1) |
| Feed Wires (including ground)                  | 3                   |
| Total Amps (International)                     | 3.8 (3.4)           |
| 10 ft. Cord/Plug [attached]<br>(International) | Yes<br>(No)         |

### SHIPPING DATA

|                          |              |
|--------------------------|--------------|
| Weight (pounds)          | 360 (164 kg) |
| Height - Crated (inches) | 46 (1168 mm) |
| Width - Crated (inches)  | 78 (1981 mm) |
| Depth - Crated (inches)  | 42 (1067 mm) |

\* Rating @ +25°F evaporator, 90°F ambient  
Figures in parentheses reflect metric equivalents rounded to the nearest whole unit.



Equipped with one NEMA-5-15P Plug  
(varies by country)

## Model Plan Views

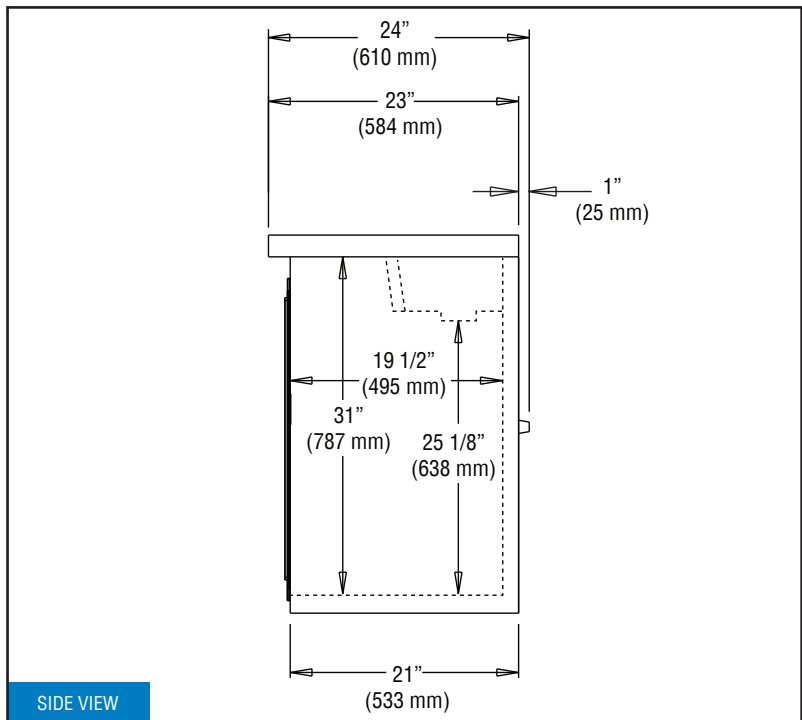
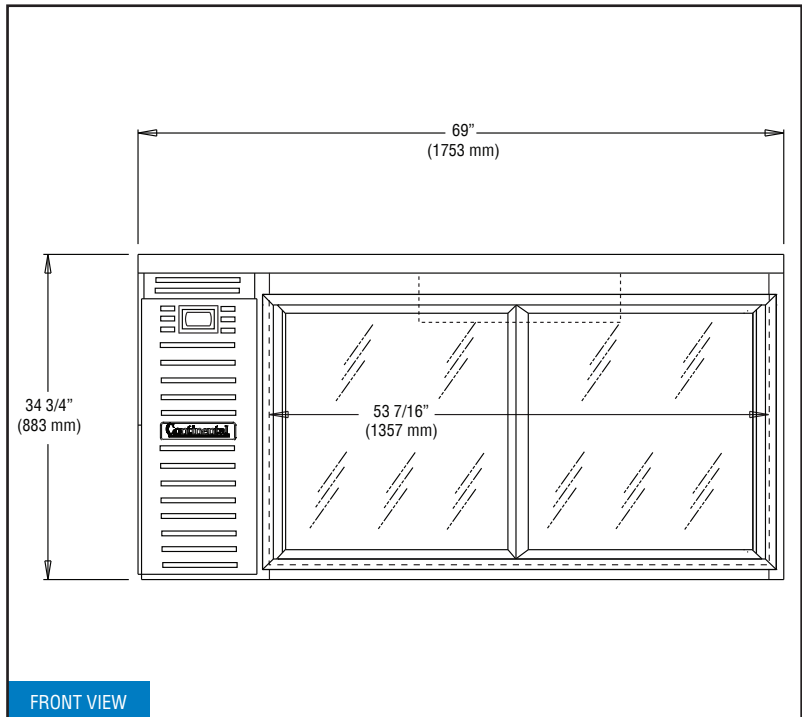

**IMPORTANT NOTE:** Models are completely front breathing and take in and exhaust air through the front grill. For proper operation, the area in front of the cabinet **must** not be obstructed in any way. A clearance of 1" on the back and 3" on the sides is recommended.

**Continental**  
Refrigerator

Toll-Free: 800-523-7138  
Phone: 215-244-1400  
Fax: 215-244-9579

539 Dunksferry Road  
Bensalem, PA 19020  
[www.continentalrefrigerator.com](http://www.continentalrefrigerator.com)

Due to our continued efforts in developing innovative products, specifications subject to change without notice.



PROUDLY  
DESIGNED & ASSEMBLED  
IN THE U.S.A.

© Copyright 2021. Continental Refrigerator.  
A Division of National Refrigeration & Air Conditioning Products, Inc.

REVISED: 5/09/2024