

BACK BAR EQUIPMENT

Model: BB79N

Natural Refrigerant R-290 Model

79" Back Bar Cooler



ENERGY STAR® Qualified Commercial Refrigerator

Textured baked black enamel finish exterior, stainless steel countertop, interior back and side panels with reinforced stainless steel floor.



Options and Accessories

(upcharge and lead times may apply)

| | |
|---------------------------------|---|
| Additional epoxy coated shelves | Food storage rated stainless steel interior (NSF-7) |
| Stainless steel shelves | Hinged glass door (consult factory) |
| Wine rack | Casters or legs |
| Riser base* | Compressor right (standard on left) |

Consult factory for other model configurations, options and accessories.

* Adding a Riser Base increases overall height 2"

Continental
Refrigerator



Project Name:

Model Specified:

Location:

Item No:

Quantity:

AIA #:

SIS #:

Standard Model Features

REFRIGERATION SYSTEM

Performance rated front breathing refrigeration system

Natural, environmentally safe, high efficiency R-290 refrigerant¹

Automatic, hot gas condensate evaporator

Extra large, balanced evaporator coil

CABINET ARCHITECTURE

High density, non-CFC polyurethane foamed-in-place insulation

Front, rear and side venting louvered grills

Magnetic snap in Santoprene™ door gaskets

Cylinder keyed security lock in each door

Stainless steel reinforced threshold

MODEL FEATURES

Low profile cabinet design

Electronic control, off cycle defrost

LED interior lighting

Easily accessible and serviceable slide-out condensing unit

¹ R-290 refrigerant meets all federal and state regulatory requirements.

APPROVAL:

Model Specifications

DIMENSIONAL DATA

| | |
|--|--|
| Net Capacity (cubic feet) | 28 (793 cu l) |
| Width, Overall (inches) | 79 (2007 mm) |
| Depth, Overall (inches) (including handles & bumpers) | 29 ³ / ₁₆ (741 mm) |
| Depth, Body Only (inches) (less doors) | 25 (635 mm) |
| Height, Overall (inches) | 34 ³ / ₄ (883 mm) |
| Bottle/Can Capacity (12 oz) | 59 (outer shelves) 68 (center shelf) |
| Number of Doors | 3 |
| Number of Shelves | 6 |

REFRIGERANT DATA

| | |
|-----------------------------|------|
| Condensing Unit Size (H.P.) | 1/4 |
| Capacity (BTU per hour)* | 2500 |

ELECTRICAL DATA

| | |
|--|---------------------|
| Voltage (International) | 115/60/1 (220/50/1) |
| Feed Wires (including ground) | 3 |
| Total Amps (International) | 3.7 (3.4) |
| 10 ft. Cord/Plug [attached] (International) | Yes (No) |

SHIPPING DATA

| | |
|--------------------------|--------------|
| Weight (pounds) | 430 (196 kg) |
| Height - Crated (inches) | 46 (1168 mm) |
| Width - Crated (inches) | 88 (2235 mm) |
| Depth - Crated (inches) | 42 (1067 mm) |

* Rating @ +25°F evaporator, 90°F ambient
Figures in parentheses reflect metric equivalents rounded to the nearest whole unit.



Equipped with one NEMA-5-15P Plug
(varies by country)

Model Plan Views

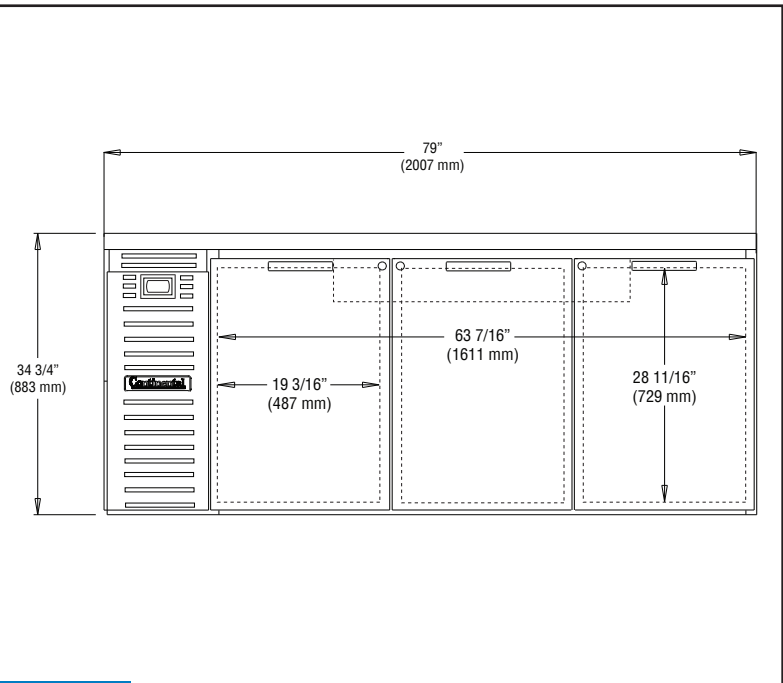

FRONT VIEW

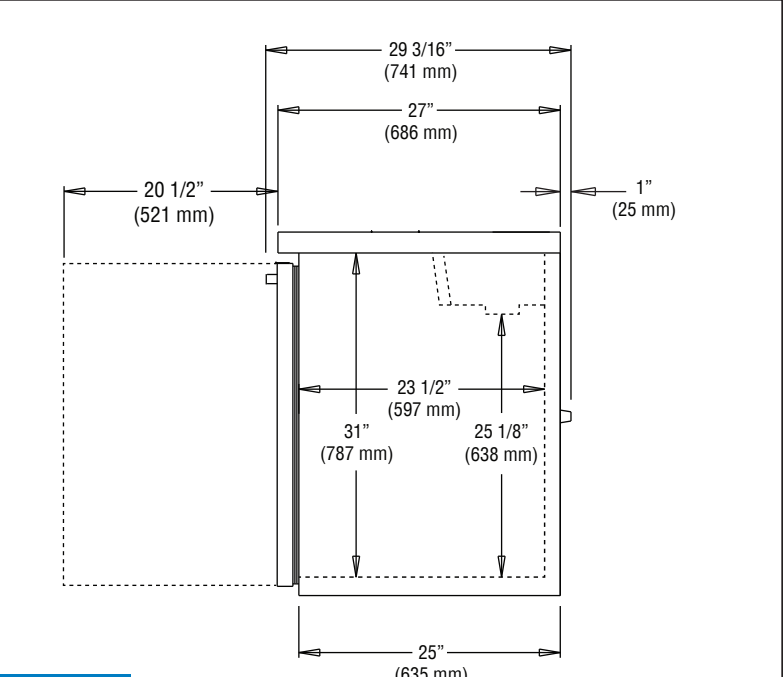

SIDE VIEW

IMPORTANT NOTE: Models are completely front breathing and take in and exhaust air through the front grill. For proper operation, the area in front of the cabinet **must** not be obstructed in any way. A clearance of 1" on the back and 3" on the sides is recommended.



Toll-Free: 800-523-7138
Phone: 215-244-1400
Fax: 215-244-9579

539 Dunksferry Road
Bensalem, PA 19020
www.continentalrefrigerator.com

Due to our continued efforts in developing innovative products, specifications subject to change without notice.



PROUDLY
DESIGNED & ASSEMBLED
IN THE U.S.A.

Intertek

© Copyright 2021. Continental Refrigerator.
A Division of National Refrigeration & Air Conditioning Products, Inc.

REVISED: 5/7/24